

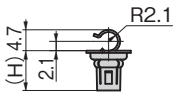

AC-1025-Q-14

[AC-1025-Q-14
AC-1025-Q-4]

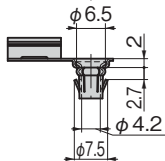
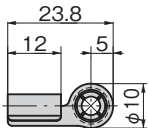

[AC-1025-Q-13]

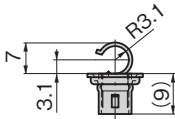
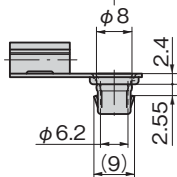
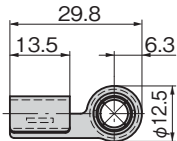

특징 Feature

- 스텐레스제로 내식성이 뛰어납니다.
- 로드를 간단히 연결할 수 있는 부쉬입니다.
- 진동에도 떨어지지 않습니다.
- This product is made of stainless steel, providing excellent corrosion resistance.
- This bush can be easily connected to the rod.
- The connection withstand even under vibration.

사양

- 재질: 스텐레스 강판(SUS304)
- 표면 마무리: 배럴 연마

Specifications

- Material: Stainless steel plate (SUS304)
- Finish: Barrel polishing

상품번호 Product No.	RoHS 10	적용 로드 Applicable rod	부착 구멍 Installation hole	적용 판 두께 Applicable plate thickness	(H)	제품질량(g) Mass	코드 Code
AC-1025-Q-13	●	φ6	φ8.5	2~2.5	9	2	04419
AC-1025-Q-4	●	φ4	φ6.5	4~4.5	11	2	04301
AC-1025-Q-14	●			2~2.5	9	2	03000

●: RoHS10 대응품 ▲: RoHS10에 대응 가능합니다.