

특징 Feature

- 도어 표면의 나사 머리 돌출이 적은 스마트형
- Screw heads from door surface are not projected largely so they are smart.

사양

[C-281]	● 재질: 패삭 황동봉(C3602BD) ● 표면 마무리: 크롬 도금(MBCr)
[C-1281]	● 재질: 스테인레스 강봉(SUS) ● 표면 마무리: 버프 연마
용도	● 점검 도어·창틀

Specifications

[C-281]	● Material: Free cutting brass bar (C3602BD) ● Finish: Chrome plating (MBCr)
[C-1281]	● Material: Stainless steel bar (SUS) ● Finish: Buffing
Specific use	● Inspection entrance doors and window frames



C-281-M8-10



C-281-M8-5



C-1281-B-M8-7



C-1281-B-M6-5

[C-281-M8]

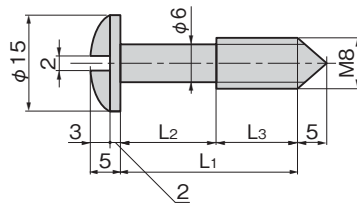

[C-281-M6]

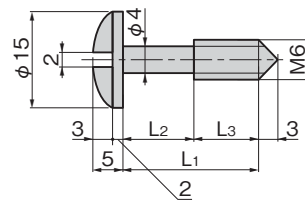

[C-1281-B-M8]

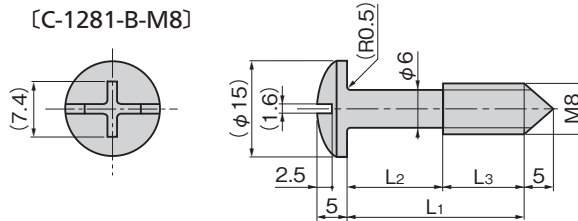

[C-1281-B-M6]

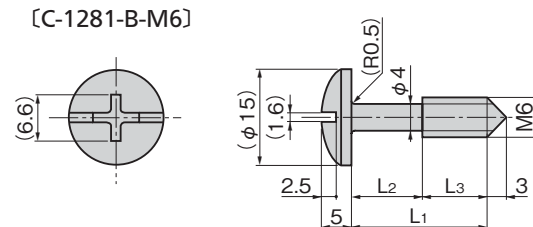

상품명 Product No.	RoHS 10	L1	L2	L3	제품질량(g) Mass	코드 Code
C-281-M6-1	●	30	20	10	10	22153
C-281-M6-2	●	30	22	8	9	22154
C-281-M6-3	●	20	10	10	9	22155
C-281-M6-4	●	20	12	8	8	22156
C-281-M6-5	●	10	2	8	7	22157
C-281-M8-1	●	35	21	14	17	22158
C-281-M8-2	●	35	25	10	16	22159
C-281-M8-3	●	30	16	14	16	22160
C-281-M8-4	●	30	20	10	15	22161
C-281-M8-5	●	25	11	14	14	22162
C-281-M8-6	●	25	15	10	14	22163
C-281-M8-7	●	20	6	14	13	22164
C-281-M8-8	●	20	10	10	13	22165
C-281-M8-9	●	45	31	14	19	22166
C-281-M8-10	●	65	51	14	24	22167

●: RoHS10 대응품 ▲: RoHS10에 대응 가능합니다.

상품명 Product No.	RoHS 10	L1	L2	L3	제품질량(g) Mass	코드 Code
C-1281-B-M6-1	●	30	20	10	9	22977
C-1281-B-M6-2	●	30	22	8	8	23264
C-1281-B-M6-3	●	20	10	10	8	22978
C-1281-B-M6-4	●	20	12	8	7	23265
C-1281-B-M6-5	●	10	2	8	6	22979
C-1281-B-M8-1	●	35	21	14	15	23266
C-1281-B-M8-2	●	35	25	10	15	23267
C-1281-B-M8-3	●	30	16	14	15	23268
C-1281-B-M8-4	●	30	20	10	14	23269
C-1281-B-M8-5	●	25	11	14	12	23270
C-1281-B-M8-6	●	25	15	10	12	23271
C-1281-B-M8-7	●	20	6	14	11	23272
C-1281-B-M8-8	●	20	10	10	11	23273
C-1281-B-M8-9	●	45	31	14	17	23274
C-1281-B-M8-10	●	65	51	14	21	23275
C-1281-B-M8-11	●	34	22	12	14	24244

●: RoHS10 대응품 ▲: RoHS10에 대응 가능합니다.