

LE-33-10~14

솔레노이드 록(통전 시 잠금형) SOLENOID LOCKS (LOCKED WHEN TURNED ON)

특징 Feature

- 앞면·뒷면 부착 검용(앞면 장착 시에는 커버를 분리하여 작업하십시오. LE-33-10은 뒷면 부착 한정입니다.)
- 원격 조작으로 잠글 수 있습니다.
- 보호 커버 부속(분리 가능)
- 잠금 확인 스위치 부착(LE-33-10-S)
- Both front and rear surface attachment. (remove the cover when choosing the front surface attachment)
- Can be locked with a remote control.
- The protective cover is included in accessories. (this can be removed)
- The locking verification switch is incorporated. (LE-33-10-S)



LE-33-10-S

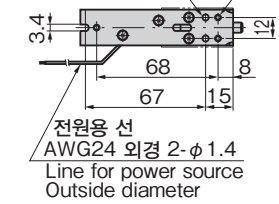
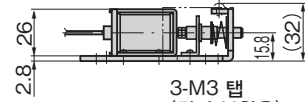
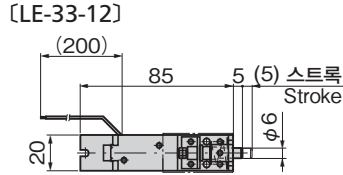

[LE-33-10·LE-33-10-S]

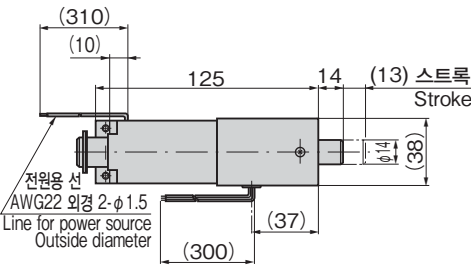

잠금/해제 확인 신호선(LE-33-10-S)
Locking/Unlocking verification signal

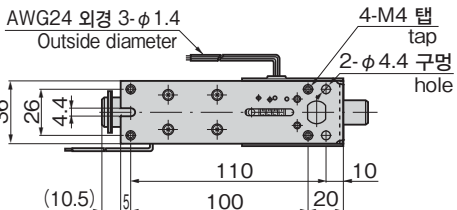

잠금: 황(COM)-녹(NO) 해제: 황(COM)-적(NC)
Locking: Yellow (COM)-Green (NO) Unlocking: Yellow (COM)-Red (NC)

[LE-33-13]

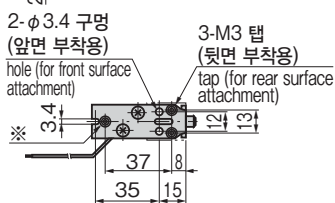
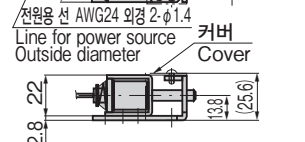
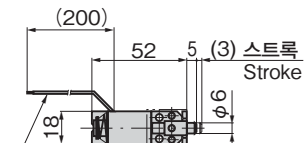

[LE-33-14]

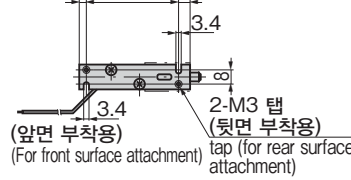
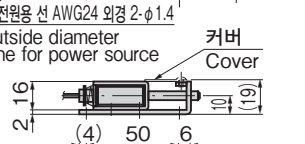
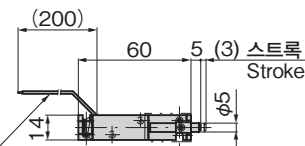

[LE-33-11]

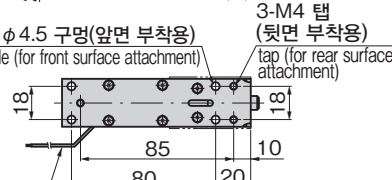
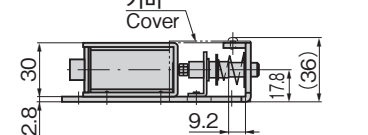
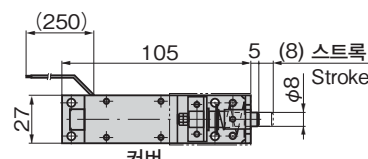

- 사양**
- 정격전압: DC24V±5%
 - 통전율: 100%(연속정격)
 - 전원을 ON하여 잠그는 솔레노이드형 전기자물쇠(통전 시 해제형)
 - 사용 주위 온도: -5 ~ +40°C (동결하지 않을 것)
 - 사용 주위 습도: 85%RH 이하 (결로가 없을 것)
- 용도**
- 패스박스·각종 케이스
- 비고**
- DC24V 이외의 사양은 특주입니다.
 - LE-33-10-S용 스위치 정격(저항 부하) AC125V·1A, DC30V·0.5A
 - 설치 구멍은 솔레노이드 부착면에 나사가 돌출되지 않도록 하십시오.
 - 본 제품의 래치 스트록 및 당기는힘, 압출력은 수평 부착 시의 값입니다.
 - 주위 온도 40°C에서 코일 온도 상승분이 약 65°C가 되는 소비전력을 정격전압(연속정격)으로 합니다.
 - 솔레노이드에 연속 통전하면 고온(70°C 전후)이 됩니다. 손이 닿을 우려가 있는 경우에는 방열을 고려한 후 화상 방지 조치를 하십시오.
 - 통전 작동 시에는 래치에 대한 부하를 제거하십시오.
 - 솔레노이드에 극성(+/-)은 없습니다.

- Specifications**
- Rated voltage: DC24V±5%
 - Duty cycle: 100% (continuous rating)
 - To be locked by turning on power (excitation locking type)
 - Ambient temperature: -5°C to +40°C (non-condensing)
 - Operating humidity range: 85%RH or less (non-dewing)

- Specific use**
- Pass boxes and various cases
- Remarks**
- Rated of switch (resistance load) for LE-33-10-S: AC125V 1A. DC30V 0.5A.
 - Make sure that the screw does not protrude from the solenoid installation surface.
 - The latch stroke, the retraction force and the extension force are value in the horizontal installation.
 - The rated voltage (continuous rating) is at a power consumption that causes the temperature of the coil to reach 65°C when the ambient temperature is 40°C.
 - When continuously energized, the solenoid becomes hot (around 70°C). If there is a risk of it being touched, measures should be taken to prevent burns with consideration given to heat radiation.
 - Remove the load on the latch when operating electrically.
 - Solenoid has no polarity (+/-).

상품번호 Product No.	RoHS 10	소비전력(W) Consumption power	래치 압출력(수평 시) N Latch extension force(at horizontal)	제품질량(g) Mass	코드 Code
LE-33-10	▲	9.5	4.9	680	50201
LE-33-10-S	▲	9.5	4.9	685	50202
LE-33-11	▲	6	2.54	315	50119
LE-33-12	●	3.5	0.78	165	50120
LE-33-13	▲	2.5	0.98	92	50121
LE-33-14	●	2	0.49	60	50122

●: RoHS10 대응품 ▲: RoHS10에 대응 가능합니다.