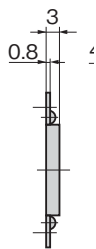
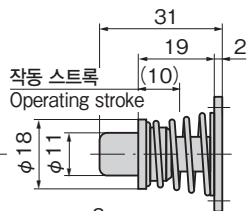
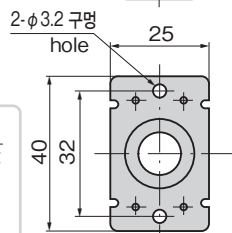
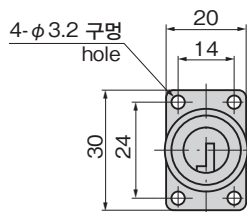
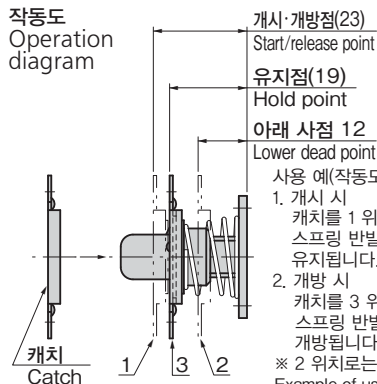
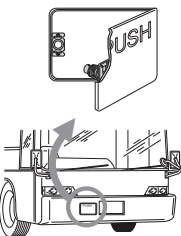

C-71

작동도
Operation
diagram사용 예
Example of
application

특징 Feature

- 도어를 가볍게 밀면 닫히고, 다시 밀면 스프링 작동으로 도어가 열립니다.
- 자석을 사용하지 않으므로 자성을 싫어하는 장소에 최적입니다.
- 스프링은 스테인레스제로 내식성이 뛰어납니다.
- 급유구 등의 외장 및 서비스 박스 등의 내장 등 양쪽으로 사용 가능합니다.
- By pushing this catch lightly, the door will closed. Push the catch again, the door opens as the spring works.
- Any magnet is not used, suitable for area where magnetic influence must be avoided.
- Spring is made of corrosion-resistant stainless steel.
- Suitable to be used for the oil lid, service boxes.

사양	<ul style="list-style-type: none"> ● 재질: 본체/폴리아세탈(POM) 캐치/스테인레스 강판(SUS304) ● 유지력: 78N
용도	<ul style="list-style-type: none"> ● 특장차·컨테이너·진동기기·버스 내외장·각종 캐비닛 도어
비고	<ul style="list-style-type: none"> ● 도어 회전축에서 제품 중심까지는 200mm 이상으로 설정해 주십시오.
Specifi-cations	<ul style="list-style-type: none"> ● Material: Main unit: Polyacetal (POM) Striker: Stainless steel plate (SUS304)
Specific-use	<ul style="list-style-type: none"> ● Specially equipped vehicles, container, oscillation equipment, bus's interior and exterior, various cabinet doors
Remarks	<ul style="list-style-type: none"> ● Leave at least 200mm between the centre of the product and the door's axis of rotation.

상품번호 Product No.	RoHS 10	제품질량(g) Mass	코드 Code
C-71	●	15	21362

- : RoHS10 대응품
- ▲: RoHS10에 대응 가능합니다.