

C-368

스텐레스제

**해치 록**
HATCH LOCKS**C-368****특징 Feature**

- 원 액션으로 개폐가 가능합니다.
- 손잡이부는 수지 본체·캐치는 스텐레스제로 내식성이 뛰어납니다.
- Can be locked/unlocked by one-action.
- The handgrip is made of plastic and the main body and catch are made of stainless steel so it's corrosion-resistant.

사양

- 재질:
손잡이/폴리아미드66(PA66)
본체·캐치/스텐레스 강판(SUS304)
- 표면 마무리: 본체·캐치/배럴 연마
- 표준색: 아이보리
- 제품질량: 91g

용도

- 선박

**Specifi-
cations**

- Material:
Handgrip: Polyamide 66 (PA66)
Main body/Catch: Stainless steel plate (SUS304)
- Finish: Main body/Catch: Barrel polishing
- Standard color: Ivory
- Mass: 91g

Specific use

- Ships

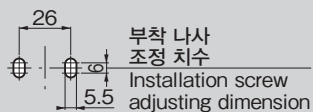
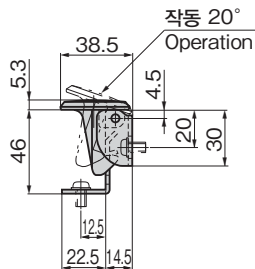
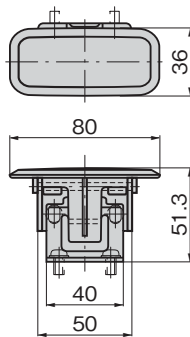
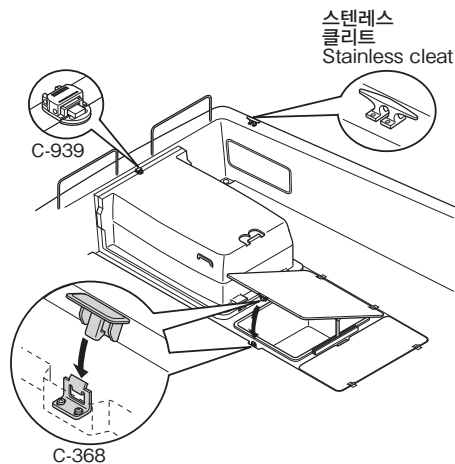
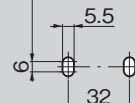
사용 예
Example of application캐치 측 부착 치수
Installing dimension on side of catch부착 나사
조정 치수
Installation screw
adjusting dimension손잡이 측 부착 치수
Installing dimension
on side of handgrip

상품명 Product No.	RoHS 10	코드 Code
C-368	●	22241

- : RoHS10 대응품
- ▲: RoHS10에 대응 가능합니다.