



K-1855-1



K-1855-2

특징 Feature

- 부착면의 돌기가 적은 평면 타입입니다.
- 스텝 수납 시에는 스프링으로 누르고 있기 때문에 진동 등으로 풀리지 않습니다.
- The flush type which have few projections on the installed surface.
- When the gate step is housed, it is held firmly by the spring, so that it will not turn in reverse even become subject to vibration.

사양	● 재질: 냉간 압연 스텐레스 강판(SUS304) ● 표면 마무리: 광택 배럴 연마
용도	● 특장차·플랫 보디·선박 등의 스텝

Specifications	● Material: Cold rolled stainless steel plate (SUS304)
Specific-use	● Finish: Gloss barrel polishing ● The step of specially equipped vehicles, flat bodies and ships

사용 예
Example of application

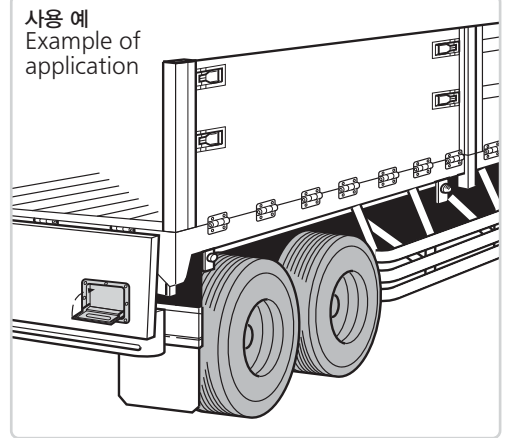

상품번호 Product No.	RoHS 10	제품질량(g) Mass	코드 Code
K-1855-1	●	1,685	31096
K-1855-2	●	700	31036

●: RoHS10 대응품
▲: RoHS10에 대응 가능합니다.

[K-1855-1]

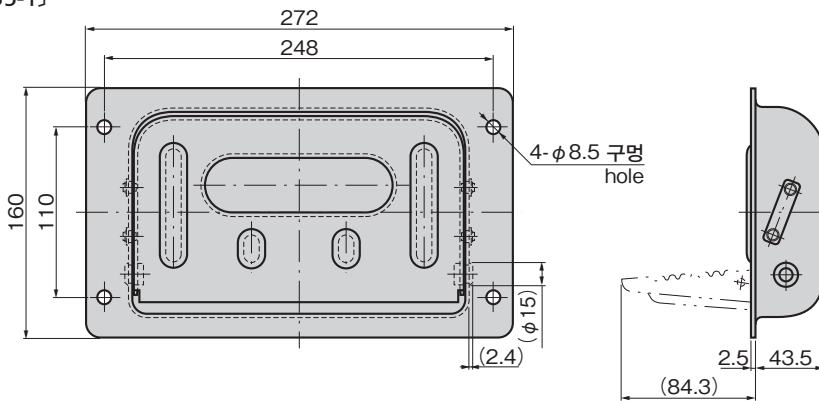

패널 구멍 치수(1/2)
Panel drilling dimension

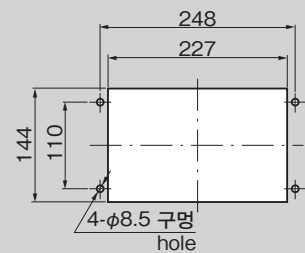

[K-1855-2]

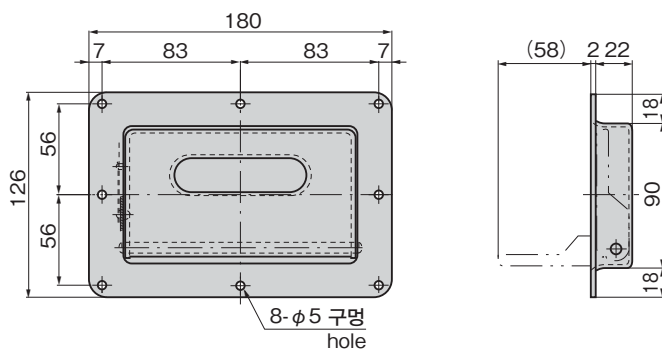

패널 구멍 치수(1/2)
Panel drilling dimension

